

These drawings and specifications are the property of H2W Technologies, Inc. They are issued in confidence and shall not be reproduced, copied, or used without written permission from H2W Technologies, Inc. (www.h2wtech.com)

REVISION TABLE					
REV	ECN#	DESCRIPTION	REV BY	APPROVED	DATE
---	---	Original Drawing	OOG	MPW	4-29-13

PARTS HAVE BEEN HIDDEN
TO SHOW MOUNTING HOLES

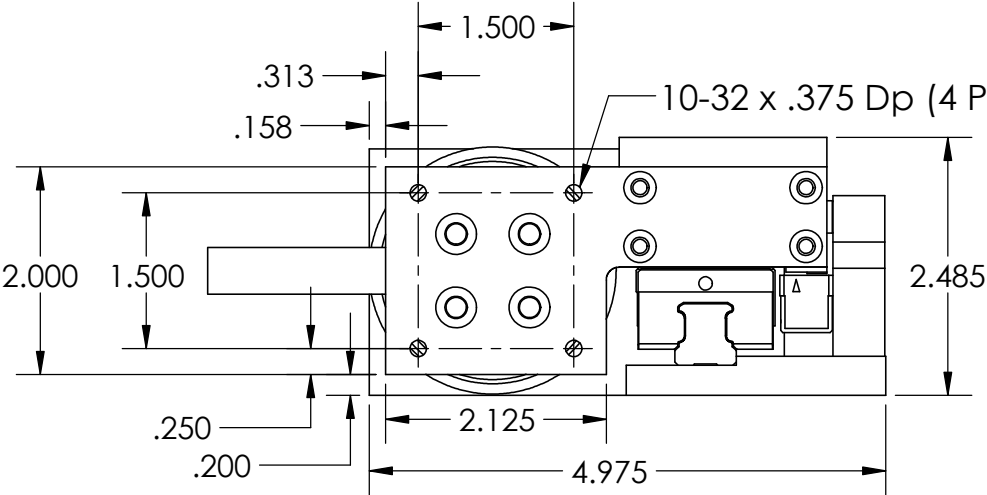
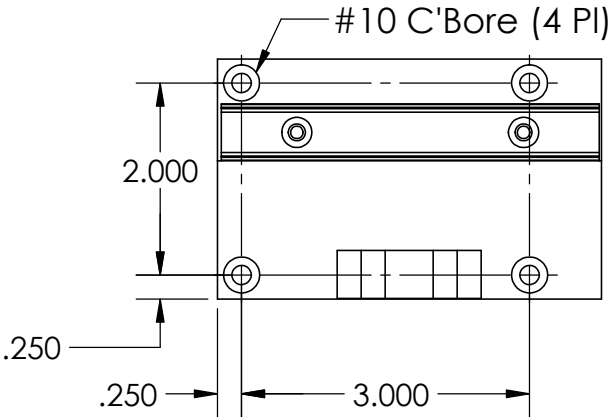

10-32 x .40 Dp (6 Pl)

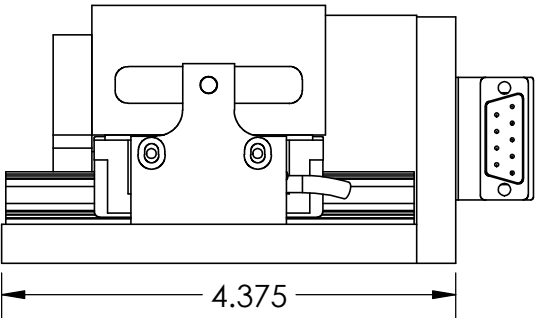
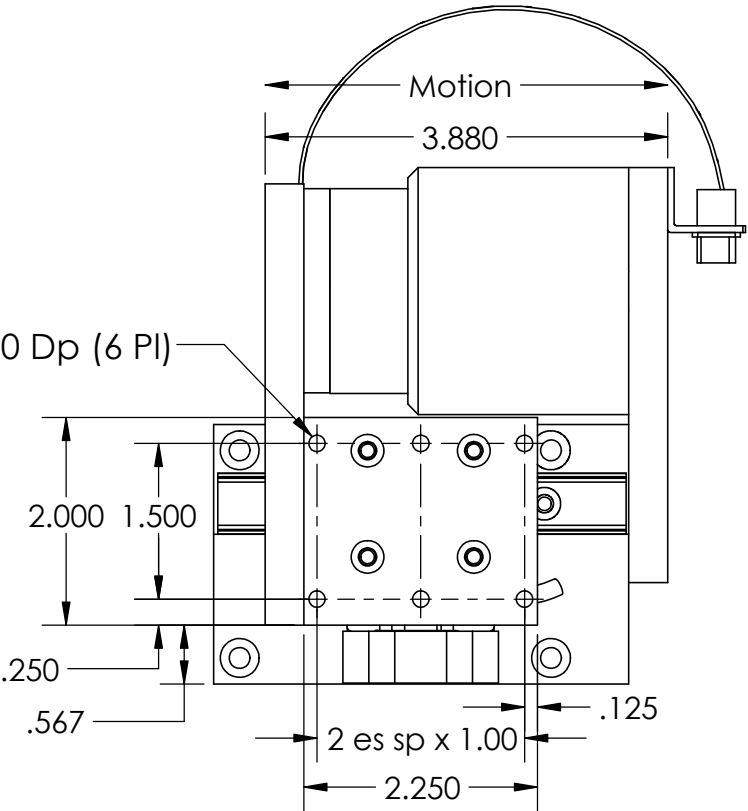

MOTOR SHOWN AT MID-STROKE

UNLESS SPECIFIED OTHERWISE: All dimensions are in inches Standard Tolerances are as follows .XXX ±.005 ANGLES ±1° .XX ±.010 FILLETS .010 .X ±.020 CORNERS .010 Remove All Burs and Sharp Edges	MATERIAL		TITLE	
	FINISH		Voice Coil Positioning Stage Model #: VCS15-084-LB-01-MCS	
DRAWN	DATE	APPROVED	DATE	DWG #
OOG	4-29-13	MPW	4-29-13	31-0624
				REV

				SHEET
				1 of 2

VOICE COIL POSITIONING STAGE SPECIFICATIONS (Bottom Axis)		
Motor P/N	NCC15-24-050-1R	
Stroke	1.50"	38.1 mm
Encoder Resolution	1 micron	
Bearing Type	Linear Bearing	
Moving Mass	1.33 lbs	604 grams
Total Mass	3.91 lbs	1775 grams
Resistance @ 20C	1.9 ohms / 7.8 ohms	
Inductance @ 20C	1.4 mH / 5.8 mH	
Electrical Time Constant	0.74 msec	
Motor Constant	1.48 LBS/SQRT(Watt)	6.59 N/SQRT(Watt)
Force Constant	2.04 LBS/Amp or 4.13 LBS/Amp	9.08 N/Amp or 18.38 N/Amp
Back EMF	0.23 V/ips or .46 V/ips	9.08 V/m/sec or 18.38 V/m/sec
Continuous Force	8.4 LBS	37.4 N
Max Power @ 100% Duty	32 Watts	
Peak Force	25.2 LBS	112 N
Max Power @ 10% Duty	291 Watts	

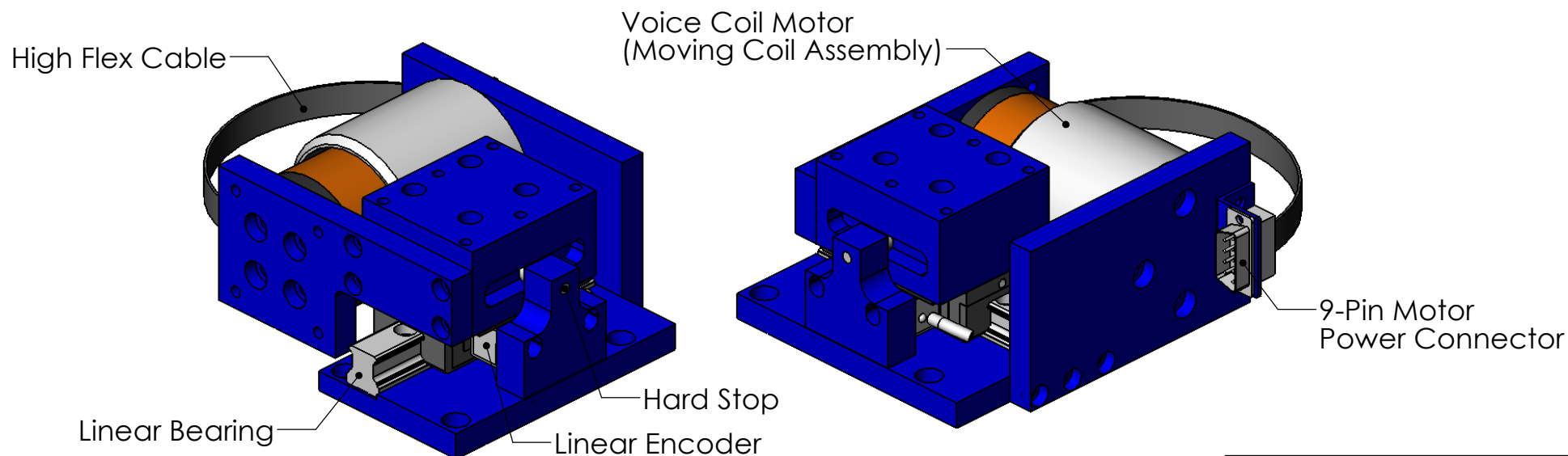

TITLE	Voice Coil Positioning Stage Model #: VCS15-084-LB-01-MCS		
DWG #	31-0604	REV	---
SHEET	2 of 2		